

# STATEMENT OF QUALIFICATIONS

MP&E Engineering

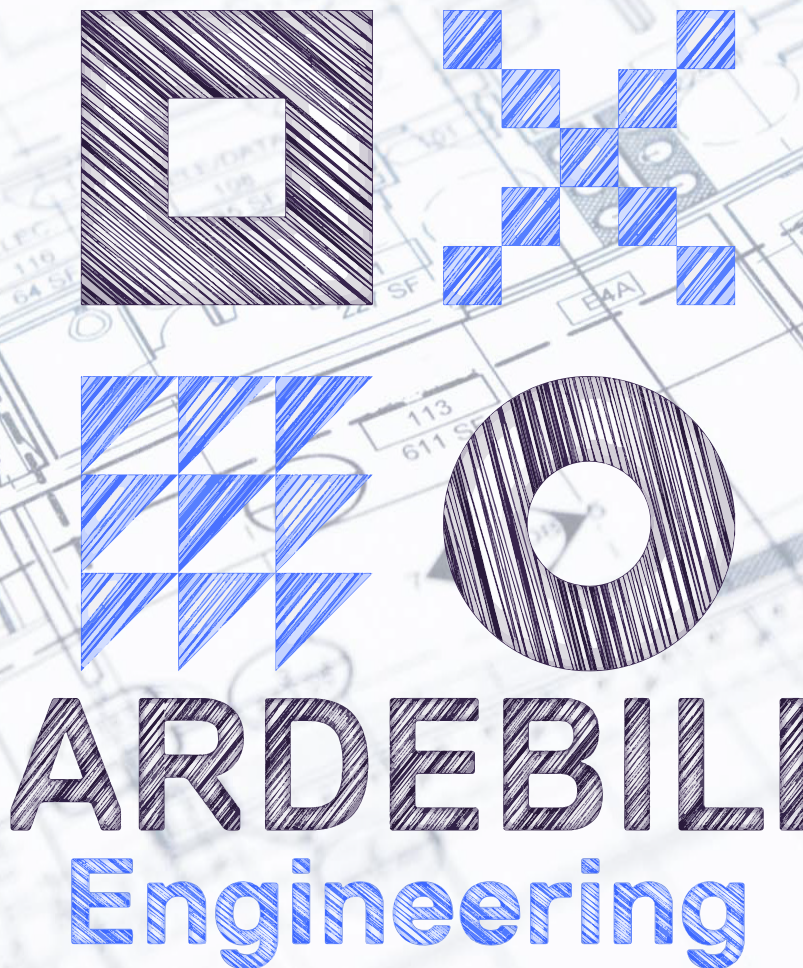

THE BEST WAY TO PREDICT THE FUTURE IS TO ENGINEER IT



# Let's Engineer the Future Together.

## WHAT WE DO:

Based on the priorities and project type, we tailor our approach to accommodate your project requirements.

We provide full-service mechanical, plumbing, and electrical engineering throughout the United States. Our diversified portfolio represents a full range of markets. Our services are provided on a local and national basis.

## HOW WE DO IT:

Our approach to all projects includes listening, learning, planning, exploring, designing, coordinating, and delivering.

We use the most efficient and cost-effective designs but realize that different types of projects have different priorities. In all cases, we consider quality, cost, life span, maintenance requirements, and energy efficiency.

Our leadership team will be involved in the entire life of the project. Our focus and responsibility is to ensure efforts meet and exceed client's expectations as well as project requirements.

## MARKETS WE SERVE:

Storage Facilities  
Schools  
Healthcare / Medical  
Fitness Centers  
Resorts / Hotels  
Industrial / Office  
Retail / Restaurant  
Hospitality / Multi-Family  
Cultivation / Agriculture  
National Accounts



MECHANICAL



PLUMBING



ELECTRICAL





# Engineering Successful Relationships.

## WHO WE ARE:

Ardebili Engineering was established in Scottsdale, AZ by Omid Ardebili in 2009 with a vision to create a collaborative workplace where successful client relationships are engineered.

We are committed to our people and clients first. We foster a creative workplace that inspires our team to reach their full potential while putting our clients at ease that their projects are in the best hands. To do this, we practice open and honest communication. We believe great designs are born from great culture and working relationships.

Our diversified portfolio represents a full range of markets where we can provide our services on a local or national basis.

The power of partnering with Ardebili Engineering is the knowledge and professionalism that comes from a team that successfully completes more than 800 projects annually. With inherent and comprehensive knowledge of the state and local requirements, we feel truly equipped to produce detailed and accurate documents on time, every time.

**While providing efficiency, we believe that quality is non-negotiable.**

**7000+**

PROJECTS COMPLETED

**50+**

OPERATIONS TEAM

**4**

LOCATIONS

**2009**

YEAR ESTABLISHED

**40+**

STATES

**Infinite**

POSSIBILITIES



# Our Fields of Experience.

- Agricultural / Controlled Environment
- Airports
- Assisted Living / Behavior Health
- Automotive
- Bowling Alley
- Brewery / Winery / Restaurants
- Carwash
- Childcare / Daycare
- Church
- Cleanroom
- Coffee Shop
- Convenience Store / Gas Station
- Distribution Center
- Fitness / Gym
- Grocery
- Hazardous
- Healthcare Center
- High Rise Offices
- Hospital
- Hotel / Motel / Resort
- Justice
- Lab
- Mixed Use
- Modular Structure
- Multi-Family
- National Chain Accounts
- Office
- Private Education
- Public School K-12
- Public Work
- Residential
- Retail
- Salon / Barbershop
- Shell Building
- Shipping Container / POD
- Solar
- Spa / Health Spa
- Sports Facility / Field / Stadium
- Surgery Center
- University / College
- Vet / Pet Resort / Dog Kennel
- Warehouse
- Welding





# Our Areas of Expertise.



## MECHANICAL

- Ventilation & Indoor Air Quality
- Chilled & Heated Water Systems
- Heating & Cooling Load Calculations
- Kitchen Exhaust Systems
- Central Plant System Design
- Site Evaluation
- Space Pressurization Control
- Humidity & Dehumidification Control
- Temperature Control & Specifications
- Under Floor Air Distribution
- Heating, Ventilation & Air Conditioning (HVAC) Distribution



## PLUMBING

- Isometric Diagrams
- Compressed Air Systems
- Storm Water Drain Systems
- Natural Gas & Propane Piping Design
- Domestic Water & Waste Piping Design
- Medical Gas Piping Systems
- Sustainable Plumbing Design
- Booster Pump Systems



## ELECTRICAL

- Interior & Exterior Lighting Analysis
- Lighting Systems & Control Design
- Emergency Egress Calculations
- Energy Code Compliance Evaluation
- Interior & Exterior Lighting Design
- Lighting Design Review
- Solar System Design
- Power System Design & Distribution
- Hazardous Classifications
- Clean Room Applications
- Emergency & Standby Power Generation
- Existing Systems Evaluation
- Electrical Equipment System Design
- Motors & Motor Control Centers
- Load Calculations
- Fault Current & Short Circuit Calculations
- Power Upgrade



## SPECIALTY

- Industrial Processing
- Fire Protection Reports
- Design Specific Water & Hydration Irrigation
- Process Piping
- Co-Generation & Energy Recovery Systems
- Multi-Tier Cultivation Design
- Hydronic Heating Systems
- Greenhouse Infrastructure & Outdoor Agriculture
- Process Flow In Throughput For Extraction Specific Equipment & Designs
- Water Conservation & Reclamation
- Control System Infrastructure
- Cold Storage Rooms, Walk In Coolers
- Secondary Containment
- Ventilation Systems
- Co2 Delivery Systems



# Ardebili's Proven Process.

Our team takes pride in being process driven and streamlining each project from start to finish.

**Transparency**  
is the key to building  
**Successful Relations**



## Project Acquisition

Account Management team will initiate the project setup.

- Gather scope of work to draft proposals and modify accordingly.
- Assist in pricing and contract matters such as negotiations.
- Post contract approval initiate project set up.
- Send out welcome emails connecting the client to the assigned project managers.



## Project Management

Project Managers lead the team of drafters and designers ensuring client satisfaction and project delivery in a timely manner.

- Manage MP&E requirements.
- Communicate with clients on deadlines & scope of work.
- Leading designers to complete deliverables on time.
- Engineers perform quality check pre-submittal.
- Provide construction documents & deliverables.



## Invoicing

Finance team will secure payment during and upon completion of the project.

- Issuing retainer, progress and final Invoices.
- Take action on delayed payments.
- Secure Payment and close out project books.





# Ardebili's Three Uniques.

What **differentiates** us from our **competitors**.



We are a **Process Driven Company**.

We have a proven process in place to ensure project success is achieved from project conception to completion. Our process ensures efficiency and repeatable outcomes. We take pride in providing exceptionally streamlined client experience with every project.



We have **True MP&E Collaboration**.

Our Mechanical and Plumbing Engineers work side-by-side with our Electrical Engineers to ensure coordination throughout the project and provide the best end product to our clients.



We **Manage Deadlines without Compromising Quality**.

Our experienced project managers and engineers have the ability to adapt to changing time-frames without sacrificing the grade of our drawings.



# Ardebili's Core Values.

What **We Stand for.**



**DEDICATED TO EXCEL.**



**DO IT WITH CARE.**



**EVERYONE IS A LEADER.**



**STRENGTH THROUGH HUMILITY.**



**THERE IS ALWAYS A SOLUTION.**





# Project Design & Delivery Step By Step.

## What Is The Typical Client Experience?

01. Send project requests to account management team.
02. Receive a proposal based on the scope of work provided.
03. Execute the contract and complete the new client on-boarding form.
04. Retainer invoice will be sent. Project will be released for scheduling upon payment.
05. Welcome email is sent introducing the assigned project managers.
06. Project managers will lead the team of designers and drafters to complete the project in a timely manner.  
In this phase, any information related to the project should be forwarded to the project managers.
07. Progress Invoices will be sent upon the completion of the contracted tasks.  
Failure to clear invoices may delay project progress.
08. A final review sets will be provided at 75% or 90% depending on the project type.
09. Final deliverables will be provided upon remittance of the final invoice.

Throughout the entire process, there will be direct and clear communication with the project managers, account managers, director of finance and the director of operation.



# Get to Know Our Leadership Team.



**OMID ARDEBILI, P.E.**  
C.E.O, Principal

Omid Ardebili founded Ardebili Engineering LLC in 2009 on one principle - engineering is not just about the drawings provided, it is about the relationship building between teams and clients. Cultivating that relationship is a key factor in being able to engineer a future together. He is a licensed electrical engineer with expertise in the evaluation of existing systems, site verification, specifications development, project management, quality control and construction administration. He's also a dedicated team leader, visionary, and an entrepreneur. Omid received his degree in electrical engineering from Arizona State University, and is licensed in 38 states. He works tirelessly to build long-term and strategic relationships and takes pride in delivering responsive and quality services. More so, he takes great satisfaction in knowing he has built a company that every employee is proud to be a part of.



**TATIANA RAMIREZ**  
C.O.O

Tatiana has over seven years of experience in engineering. She prioritizes team development by encouraging the Ardebili team to achieve strategic goals and meet client needs. She is a true integrator - working across disciplines and with all levels of staff and leadership to build efficiencies. Tatiana is known to be process driven, streamlining internal processes to promote efficiency is one of her aptitudes. She constantly challenges herself to never settle for just 'good' - she wants greatness - in her communication with team and clients, and honing specialty skills and practices that move the team, and industry forward. Tatiana received her bachelor's degree in engineering with an emphasis on electrical systems design from Arizona State University.



**JESSE EVANS**  
Director of  
Operations

Jesse Evans has over 23 years of experience with plumbing and mechanical design. Performing as the Director of Operations for Ardebili Engineering, he is overseeing the entire MPE workforce. Jesse has continued to utilize his skills to provide quality control and management on a wide range of projects. His experience spans over a wide variety of industries including hospitality, storage facilities, restaurants, commercial, retail, education, breweries, healthcare, and office spaces. Jesse is excellent at building lasting relationships with clients and is known for caring about client needs. He is a natural leader, and is truly passionate about his craft. He works with his team to provide timely and innovative designs, even under compressed schedules. Jesse understands the need to continue to bring in talented individuals that meet the company's Core Values, while preserving the culture that we cherish.





# Get to Know Our Leadership Team.



**MATTHEW FABROS**  
Account Manager

Matthew Fabros is an enthusiastic and detail driven individual who enjoys working with people to help provide solutions to their engineering needs. Timely, organized, and able to multitask to ensure all clients' needs are met in a satisfactory way without compromising the quality of services received. His goal is to maintain and strengthen client relationships through transparent communication, trustworthy relations, and flexibility.



**FAISAL HALIS, P.E.**  
Mechanical  
Department Manager

Faisal is a licensed professional mechanical engineering experienced in the design of heating, ventilation, air conditioning and plumbing systems. His experience covers a variety of projects and market sectors, including multi-family, hospitality, hotel, commercial office, health care, government, industrial, retail and restaurant projects. Faisal directs the production of mechanical and plumbing drawings, while providing interdisciplinary coordination. Faisal earned a bachelor's degree in mechanical engineering from Wayne State University, and is licensed in 22 states. He takes pride and great care in the quality, accuracy and delivery of construction documents, specifications, shop drawings and RFIs.



**PATRICK CRONAN, P.E.**  
Electrical  
Department Manager

Patrick is a registered professional engineer who brings more than 8 years of experience to the Ardebili Engineering team. He provides design solutions to complex projects, and prides himself on delivering quality results. He enjoys the complexity and challenges that project design entails. Patrick has vast experience in a multitude of sectors including but not limited to restaurants, healthcare, multifamily, retail, and industrial facilities. He has an acute attention to detail and is active in engineering decisions involved in construction drawing assembly. Patrick attended the CSU, Sacramento where he earned his degree in electrical engineering.



# Select Projects.



**SURGERY CENTER**  
Prescott, AZ

**Quick Description:**  
25,000 SF Ground Up Surgery Center

Ardebili Engineering provided mechanical, plumbing, and electrical engineering for a new 25,000 SF surgery center. The three-story surgery center posed a number of challenges to the design and engineering teams as there were many limitations to the site. Our engineers were not able to place equipment on the roof because of screening and building height limitations, and were unable to place equipment on the ground due to site limitations. The team was tasked with identifying systems that would comply with code, provide the needs of a surgery center, but that was also able to be physically installed. The team worked closely with the client to provide different options for the design of the project and modeled the HVAC system to be constructible while still meeting the unique performance requirements of a surgery center.



**VA HOSPITAL  
MULTIPLE PROJECTS**  
Fresno, CA

**Quick Description:**  
CT Scan and MRI replacement projects

For the VA Hospital in Fresno, California, Ardebili Engineering provided engineering modernizations to the CT Scan, MRI and associated support rooms. Complying with the requirements of the VA Hospital was a challenge for both the general contractor and the engineering teams, but ultimately the individuals from both partnered together. VA personnel and contractors joined the Ardebili team on site to survey existing conditions to set up the job for success by identifying the existing systems in the aged building to be reused, demo or upgraded capacity to serve the space. Ardebili was later brought on for additional projects at the VA including a compounding pharmacy project and replacement of a second CT Scan machine in the same facility. We also were able to assist in the emergency conversion of a hospital general patient ward into a negative isolation COVID ward.





# Select Projects.



**PRINCESS STORAGE**  
Scottsdale, AZ

**Quick Description:**  
100,000+ SF GROUND UP

Ardebili Engineering completed mechanical, plumbing, and electrical engineering for a new 100,000+ SF storage facility. The two-story building plus two basements posed a number of challenges to the design and engineering teams. Our engineers were limited on where equipment could be placed on the floorplan due to height restrictions of the building. The team was tasked with identifying system location that would comply with code, provide the needs of heating and cooling, and was also able to be physically installed. The team worked closely with the client to provide different options for the design of the project and modeled the HVAC system to be constructible while still meeting the client specific requirement for the design.

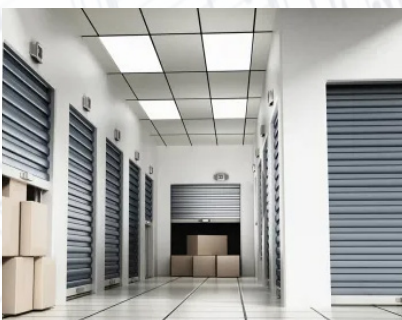

**FIGUEROA STORAGE**  
Los Angeles, CA

**Quick Description:**  
100,000+ SF GROUND UP

Ardebili Engineering completed mechanical, plumbing, and electrical engineering designs for Figueroa Street Self Storage in Los Angeles, CA, a fully conditioned, six story, 100,000+ SF storage facility with offices on the lower level. The five story building plus a basement posed a number of challenges to the team as there was a limitation to the drainage design on site. Our engineers had to design a system with the ability to drain the site into a lift station system inside the building to ensure the site would not flood. The team worked closely with the civil engineers and the architect to provide a cost effective design for the project, and modeled the system to be constructible while still meeting the city specific requirement for the design.



# Experience - Medical & Dental



- ABHS Behavioral Health Center, McNary, AZ
- Agave Pediatrics, Goodyear, AZ
- Aurora Behavioral Health Center, Tempe, AZ
- Dr. Bryan Tran, DDS, Phoenix, AZ
- Dr. Ptak Medical Office, Scottsdale, AZ
- Every Smile Dental, Mesa, AZ
- Honor Health Thompson Peak, Scottsdale, AZ
- Honor Health Gastroenterology Offices, Phoenix, AZ
- Honor Health Primary & Urgent Care Facility, 38K SF, Scottsdale, AZ
- Honor Health Primary Care Sleep Center, Scottsdale, AZ
- Honor Health Primary Care, Scottsdale Rd, Scottsdale, AZ
- Honor Health Primary Care, Tempe, AZ
- Honor Health TPK Primary Care, Scottsdale, AZ
- Next Care, Gilbert, AZ
- Premier Orthodontics Union Hills, Phoenix, AZ
- Walman Eye Center, Phoenix, AZ
- West Valley Pediatric, Buckeye, AZ
- VA Hospital, Multiple projects
- Surgery Center, 25K SF





# Experience - Restaurant & Entertainment

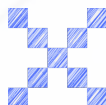
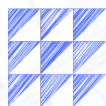

- Alamo DraftHouse, Tempe, AZ
- Angie's Lobster, Multiple Locations, AZ
- Aramark, Multiple Projects, AZ
- Barrio Queen, Phoenix, AZ
- Barros Pizza Multiple Locations, AZ
- Bourbon and Bones, Multiple Locations
- Chick-fil-A, Tempe, AZ
- Chula's Seafood, Scottsdale, AZ
- Cold Beer & Cheeseburgers, Multiple AZ
- Copper Blues Comedy Club, Oxnard, CA
- Crab & Mermaid, Scottsdale, AZ
- Edley's BBQ, Multiple Locations, TN
- Elote Cafe, Sedona, AZ
- Fate Brewing, Scottsdale, AZ
- Goldwater Brewery, Scottsdale, AZ
- Humble Pie, Scottsdale, AZ
- Macayo's Mexican Table, Multiple Locations
- Merkins Vineyard, Cottonwood, AZ
- Modern Round, Peoria, AZ
- Ojos Locos, Multiple Locations
- Over Easy, Multiple Locations, AZ
- Pei Wei, Memorial Union ASU, Tempe, AZ
- Roll'em Up Taquitos, Multiple Locations, AZ
- Sorso Wine Room, Scottsdale, AZ
- Starbucks, ASU Campus Locations, AZ
- Thai Chili To Go, Maricopa, AZ
- The Clayton House, Scottsdale, AZ
- US Eggs, Scottsdale, AZ
- Zipps Sports Grill, Phoenix, AZ



# Experience - Storage Facilities

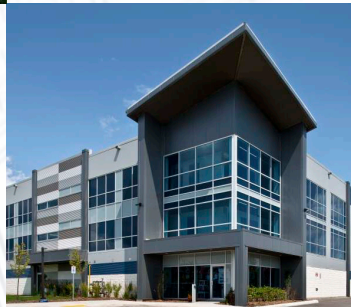
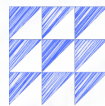

- 19th Ave Storage, 144K SF
- 365 Storage Mesquite, TX 136K SF
- Assured 360 Storage, Ft. Worth 139K SF
- Blue Cloud Storage, 241K SF
- Capital Storage, CA 199K SF
- CubeSmart Self Storage, CA 63K SF
- El Mirage Storage, Surprise AZ 141K SF
- Falcon Storage Condos, 159K SF
- Foothills Storage, 133K SF
- Haltom Storage, Haltom TX 133K SF
- Indian School Storage, AZ 179K SF
- Irvington 19 Storage, 133K SF
- Liberty Self Storage, 170K SF
- Marana RV Storage, AZ 205K SF
- Marana Storage, AZ 200K SF
- NoHo Storage, 150K SF
- Platinum Storage, Citrus & Bethany 222K SF
- Platinum Storage, Metro Parkway 185K SF
- Rockwall Storage, 147K SF
- Royce City RV and Semi Storage, 206K SF
- RV and Boat Storage Yard, 186K SF
- Self Storage, Lubbock TX 144K SF
- Self Storage, Vista CA 180K SF
- Storage 365, 19th & Southern 136K SF
- Storage 365, Honeycutt 150K SF
- Storage 365, Sweetwater 145K SF
- U-haul, Power Ranch 129K SF

**200+**

STORAGE PROJECTS

**12,500,000+**

SQUARE FEET ENGINEERED





# Experience - National Accounts

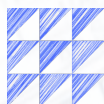

- 7-Eleven
- Church's Chicken
- Circle K
- Club Pilates
- Cold Stone Creamery
- CorePower Yoga
- Cricket
- Cycle Bar
- Dickey's BBQ
- Dunkin'
- Fatburger
- Grabba Greens
- Orange Theory Fitness
- Pacific Seafood
- Popbar
- Popeye's
- Pure Barre
- Rumble Boxing
- Salad & Go
- Scooters
- Thai Express
- TruFusion
- Verizon
- Which Wich
- YogaSix



# Experience - Corporate Office

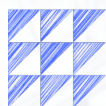

- Anasazi Plaza, Phoenix, AZ
- Arizona Water Company, Phoenix, AZ
- Chasse Building Team, Tempe, AZ
- Control Tower Small Arms, US Army
- Ideas Collide, Scottsdale, AZ
- Indwell Custom Cabinetry, Phoenix, AZ
- JDM Countertops, Phoenix, AZ
- Nelipak Office Space, Cranston, RI
- Scottsdale Promenade, Scottsdale AZ
- Spinato's Fine Foods Production Line, Tempe, AZ
- Surgenex Regenerative Medicine Headquarters, Scottsdale, AZ
- WTPC Office, Tempe, AZ
- 24/7 In-Touch Offices, Mesa, AZ





# Experience - Multifamily & Hotel

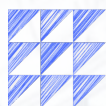

- Aspire Elite Phoenix Fairway Greens Apartments, 170K SF, Phoenix, AZ
- Cibola Vista Resort & Spa, 34K SF, Peoria, AZ
- Crown Point Apartments, 125K SF, Prescott Valley, AZ
- Eastline Village Mixed-Use, 136, 119K SF, Tempe, AZ
- Gallery Park Dual Brand Hotel, 112K SF, Mesa, AZ
- Glendale W Apartments, 46K SF, Glendale, AZ
- Hampton Inn & Suites, 63K SF, Indio, CA
- Hampton Inn & Suites, 79K SF, Lake Tahoe, CA
- Holiday Inn Express, 54K SF, Gresham, OR
- Home2 Suite & Tru by Hilton, 111K SF, Madison, WI
- Legacy Hotel, 59K SF, Phoenix, AZ
- Museum Square Apartments, 88K SF, Scottsdale, AZ
- Parkview Mixed-Use 25K SF, Scottsdale, AZ
- Redwood Apartments, 80K SF, Sonoma County, CA
- Roosevelt Point Mixed-Use, 350K SF, Phoenix, AZ
- Springhill Suites, 65K SF, Vancouver, WA
- Tru Hotel, 45K SF, Barstow, CA
- 77 on the Park, 49K SF, Scottsdale, AZ
- 7th St Multi-Family, 37K SF, Phoenix, AZ



# Experience - Industrial / Warehouse

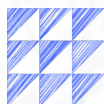

- Solar Warehouse 125K SF
- Nelipack Healthcare packaging Phoenix AZ
- Bram Flooring Warehouse AZ 14K SF
- Cabinetry Warehouse TI 52K SF
- Law Tigers Warehouse 11K SF
- National Gypsum 531K SF
- Seafood Warehouse Addition 6K SF
- Portal Warehouse Tempe AZ 27K SF
- Power Office and Warehouse 21K SF
- True Spec Golf Warehouse 14K SF
- Bobs Furniture Tucson AZ 88K SF
- Deer Valley Warehouse Phoenix AZ 16K SF
- Tacoma Seattle Box company 100K SF
- AirComm Industrial Office Tempe AZ 31K SF
- Setna IO Tempe AZ 11K SF
- Sports Center Lake Forest CA 50K SF
- Warehouse TI Thunderbird & 32nd 11K SF
- Fountain Hills TI 9K SF
- Manufacturing Facility 51K SF
- Dalewood Warehouse 20K SF





# Experience - Mixed Use

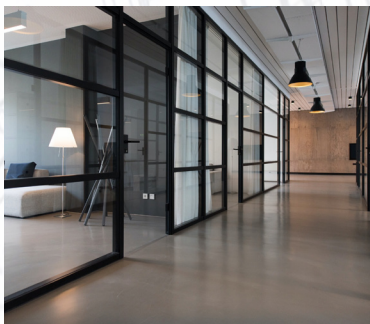
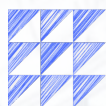

- 32nd Street North, 20K SF, Phoenix AZ
- BLUE at Eastline Village 180k SF, Tempe AZ
- The Clayton, 215K SF, Scottsdale AZ
- Cooley Station 24, 402K SF, Gilbert AZ
- Sienna Garden, 18K SF, Glendale AZ
- Store 637, 27K SF, Kingman AZ
- Espire Sports Center, 62K SF, Prescott Valley AZ
- The Artisan, 84K SF, Scottsdale
- Sunshine Acres, 17K SF, Mesa AZ
- Mixed Use TI, 71K SF, San Diego CA
- 75 on 2nd Apartments, 71K SF, Phoenix AZ
- 12 High, 69K SF, Phoenix AZ
- Museum Square Buildings, 349k SF, Scottsdale AZ



# Experience - Residential



- Deley Residence 6,500 SF
- 8436 N Golf Drive 11,131 SF
- Gala Residence Additions 7,675 SF
- Ripp's Residence Remodel 2,900 SF
- Carefree Ranch Residence 5,764 SF
- Residential Remodel 2,850 SF
- The Berry Cabin 4,200 SF
- Jomax Residence 12,000 SF
- Lot 136 Whisper Rock 5,600 SF
- Lot 5 Cochise Geronimo Village 5,000 SF
- Lot 30 Estancia 6,300 SF
- Lot 60 Estancia 6,700 SF
- Lots 14 & 15 Esperanza 10,000 SF
- Lot 212 Estancia 6,100 SF
- Lot 4 Cantabrica 10,600 SF
- Lot 195 Estancia 5,500 SF
- Plaza Lofts 3,300 SF
- 91st Place Casita 3,000 SF
- Campbell Residence 5,700 SF
- Lot 8 - Cantabrica 12,700 SF
- Ford Residence 10,500 SF
- Webster Residence 5,500 SF
- Lot 1 Cantabrica 11,700 SF
- Lot 264 Estancia 8,500 SF
- Dr Askari Residence 8,000 SF
- Garrett Family House 7,000 SF





# Experience - Worship & Public Works

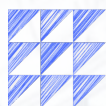

- AZ Game & Fish Bubbling Ponds, Phase 1&2, Cornville, AZ
- AZ Game & Fish, Horseshoe Ranch Storage Facility, Cordes Lake, AZ
- AZ Game & Fish, Lake Havasu Law Enforcement Aid Station, Lake Havasu, AZ
- AZ Game & Fish, Standard House, Lake Havasu, AZ
- Grace Fellowship Church, Riverside, CA
- Harvest Bible Church, Mohave Valley, AZ
- Phoenix Memorial Park, New Mausoleum, Phoenix, AZ
- Salt River Assembly of God, Peoria, AZ
- Tabor Church, Riverside, CA
- US / Canada Export Building Renovation, Champlain, NY
- Valley Life Church, Phoenix, AZ
- Vietnamese Fellowship Hall, Phoenix, AZ



# Experience - Hazardous

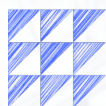

- Exterior Hazardous Material Storage Building  
3,000 SF  
Snowflake, AZ  
Description: Building holds several hazardous materials used in the client's growing and extraction processes



- Triumvirate Integrated Waste Management Facility  
48,000 SF  
Casa Grande, AZ  
Description: Hazardous waste building that includes corrosive liquids, processing, segregated container storage, acids, bases, neutrals, flammable liquids and solids and heavy metal soils/liquids with metal areas



- Ultra Health II  
5,000 SF - Tenant Improvement  
Scottsdale, AZ  
Description: Testing Lab
- Salt River Materials Laboratory  
10,000 SF  
Clarkdale, AZ  
Description: Laboratory



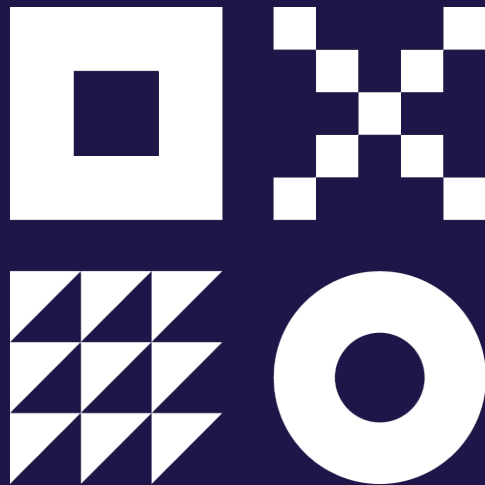

Let's Engineer the Future Together.



480.626.7072



[info@Ardebilieng.com](mailto:info@Ardebilieng.com)



[www.Arbabilieng.com](http://www.Arbabilieng.com)



Ardebili Engineering **Headquarters**

7328 E Stetson Dr.  
Scottsdale, AZ 85251

Ardebili Engineering **Dallas**

12377 Merit Dr, Ste 230.  
Dallas, TX 75251

Ardebili Engineering **Mexico**

Blvd. Luis Donaldo Colosio Murrieta 450,  
83250 Hermosillo, SON. Mexico  
(Edificio Metrocentro Local 6 Piso 6)

Ardebili Engineering **Turkey**

Atifbey Mah. Akcay Cad. No.278/3 D.1  
Gaziemir Izmir. Turkey