

# STATEMENT OF QUALIFICATIONS

MP&E Engineering

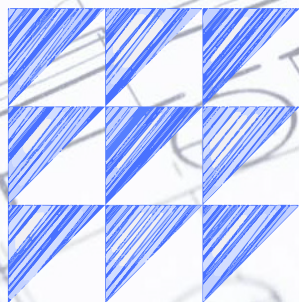
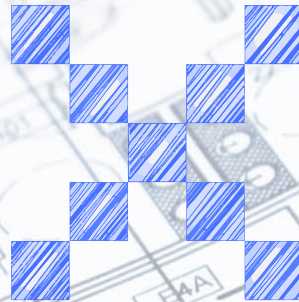

**ARDEBILI**  
Engineering

THE BEST WAY TO PREDICT THE FUTURE IS TO ENGINEER IT



# Let's Engineer the Future Together.

## WHAT WE DO:

Based on the priorities and project type, we tailor our approach to accommodate your project requirements.

We provide full-service mechanical, plumbing, and electrical engineering throughout the United States. Our diversified portfolio represents a full range of markets. Our services are provided on a local and national basis.

## HOW WE DO IT:

Our approach to all projects includes listening, learning, planning, exploring, designing, coordinating, and delivering.

We use the most efficient and cost-effective designs but realize that different types of projects have different priorities. In all cases, we consider quality, cost, life span, maintenance requirements, and energy efficiency.

Our leadership team will be involved in the entire life of the project. Our focus and responsibility is to ensure efforts meet and exceed client's expectations as well as project requirements.

## MARKETS WE SERVE:

Agriculture / Cultivation  
Educational Facilities  
Fitness Centers  
Healthcare / Medical  
Hospitality / Resort  
Industrial / Office  
National Accounts  
Residential / Multi-Family  
Retail / Restaurant  
Storage Facilities



MECHANICAL



PLUMBING



ELECTRICAL



# Engineering Successful Relationships.

## WHO WE ARE:

Ardebili Engineering was established in Scottsdale, AZ by Omid Ardebili in 2009 with a vision to create a collaborative workplace where successful client relationships are engineered.

We are committed to our people and clients first. We foster a creative workplace that inspires our team to reach their full potential while putting our clients at ease that their projects are in the best hands. To do this, we practice open and honest communication. We believe great designs are born from great culture and working relationships.

Our diversified portfolio represents a full range of markets where we can provide our services on a local or national basis.

The power of partnering with Ardebili Engineering is the knowledge and professionalism that comes from a team that successfully completes more than 800 projects annually. With inherent and comprehensive knowledge of the state and local requirements, we feel truly equipped to produce detailed and accurate documents on time, every time.

**While providing efficiency, we believe that quality is non-negotiable.**

**7000+**

PROJECTS COMPLETED

**50+**

OPERATIONS TEAM

**4**

LOCATIONS

**2009**

YEAR ESTABLISHED

**40+**

STATES

**Infinite**

POSSIBILITIES



# Our Fields of Experience.

- Agricultural / Controlled Environment
- Airports
- Assisted Living / Behavior Health
- Automotive
- Bowling Alley
- Brewery / Winery / Restaurants
- Carwash
- Childcare / Daycare
- Church
- Cleanroom
- Coffee Shop
- Convenience Store / Gas Station
- Distribution Center
- Fitness / Gym
- Grocery
- Hazardous
- Healthcare Center
- High Rise Offices
- Hospital
- Hotel / Motel / Resort
- Justice
- Lab
- Mixed Use
- Modular Structure
- Multi-Family
- National Chain Accounts
- Office
- Private Education
- Public School K-12
- Public Work
- Residential
- Retail
- Salon / Barbershop
- Shell Building
- Shipping Container / POD
- Solar
- Spa / Health Spa
- Sports Facility / Field / Stadium
- Surgery Center
- University / College
- Vet / Pet Resort / Dog Kennel
- Warehouse
- Welding



# Our Areas of Expertise.



MECHANICAL

- Ventilation & Indoor Air Quality
- Chilled & Heated Water Systems
- Heating & Cooling Load Calculations
- Kitchen Exhaust Systems
- Central Plant System Design
- Site Evaluation
- Space Pressurization Control
- Humidity & Dehumidification Control
- Temperature Control & Specifications
- Under Floor Air Distribution
- Heating, Ventilation & Air Conditioning (HVAC) Distribution



PLUMBING

- Isometric Diagrams
- Compressed Air Systems
- Storm Water Drain Systems
- Natural Gas & Propane Piping Design
- Domestic Water & Waste Piping Design
- Medical Gas Piping Systems
- Sustainable Plumbing Design
- Booster Pump Systems



ELECTRICAL

- Interior & Exterior Lighting Analysis
- Lighting Systems & Control Design
- Emergency Egress Calculations
- Energy Code Compliance Evaluation
- Interior & Exterior Lighting Design
- Lighting Design Review
- Solar System Design
- Power System Design & Distribution
- Hazardous Classifications
- Clean Room Applications
- Emergency & Standby Power Generation
- Existing Systems Evaluation
- Electrical Equipment System Design
- Motors & Motor Control Centers
- Load Calculations
- Fault Current & Short Circuit Calculations
- Power Upgrade



SPECIALTY

- Industrial Processing
- Fire Protection Reports
- Design Specific Water & Hydration Irrigation
- Process Piping
- Co-Generation & Energy Recovery Systems
- Multi-Tier Cultivation Design
- Hydronic Heating Systems
- Greenhouse Infrastructure & Outdoor Agriculture
- Process Flow In Throughput For Extraction Specific Equipment & Designs
- Water Conservation & Reclamation
- Control System Infrastructure
- Cold Storage Rooms, Walk In Coolers
- Secondary Containment
- Ventilation Systems
- Co2 Delivery Systems



# Ardebili's Three Uniques.

What differentiates us from our competitors.



We are a **Process Driven Company.**

We have a proven process in place to ensure project success is achieved from project conception to completion. Our process ensures efficiency and repeatable outcomes. We take pride in providing exceptionally streamlined client experience with every project.



We have **True MP&E Collaboration.**

Our Mechanical and Plumbing Engineers work side-by-side with our Electrical Engineers to ensure coordination throughout the project and provide the best end product to our clients.



We **Manage Deadlines without Compromising Quality.**

Our experienced project managers and engineers have the ability to adapt to changing time-frames without sacrificing the grade of our drawings.



# Select Projects.



**SURGERY CENTER**  
Prescott, AZ

**Quick Description:**  
25,000 SF Ground Up Surgery  
Center

Ardebili Engineering provided mechanical, plumbing, and electrical engineering for a new 25,000 SF surgery center. The three-story surgery center posed a number of challenges to the design and engineering teams as there were many limitations to the site. Our engineers were not able to place equipment on the roof because of screening and building height limitations, and were unable to place equipment on the ground due to site limitations. The team was tasked with identifying systems that would comply with code, provide the needs of a surgery center, but that was also able to be physically installed. The team worked closely with the client to provide different options for the design of the project and modeled the HVAC system to be constructible while still meeting the unique performance requirements of a surgery center.



**VA HOSPITAL  
MULTIPLE PROJECTS**  
Fresno, CA

**Quick Description:**  
CT Scan and MRI replacement  
projects

For the VA Hospital in Fresno, California, Ardebili Engineering provided engineering modernizations to the CT Scan, MRI and associated support rooms. Complying with the requirements of the VA Hospital was a challenge for both the general contractor and the engineering teams, but ultimately the individuals from both partnered together. VA personnel and contractors joined the Ardebili team on site to survey existing conditions to set up the job for success by identifying the existing systems in the aged building to be reused, demo or upgraded capacity to serve the space. Ardebili was later brought on for additional projects at the VA including a compounding pharmacy project and replacement of a second CT Scan machine in the same facility. We also were able to assist in the emergency conversion of a hospital general patient ward into a negative isolation COVID ward.



# Select Projects.



Ingo's  
Phoenix, AZ

Quick Description:  
Ground Up Restaurant

Ardebili Engineering successfully completed a unique restaurant project, navigating challenges presented by its distinctive bean-shaped design and flood zone location. With limited roof space available, the team worked closely with the architect to strategically position mechanical units while maintaining the building's artistic vision. Through innovative design solutions and the use of compact equipment, they maximized functionality without compromising aesthetics.

In addition to the roof considerations, the engineers tackled the issue of locating mechanical units in a flood-prone area. Collaborating with the architect and city authorities, they developed a comprehensive flood mitigation strategy. This involved elevating the equipment above projected flood levels, implementing waterproofing measures, and incorporating appropriate drainage systems. Ardebili Engineering effectively addressed the distinctive design and challenging location by emphasizing efficiency and cost-effectiveness, resulting in the successful delivery of a practical and feasible design.



Cold Beers & Cheeseburgers  
Phoenix, AZ

Quick Description:  
Chase Field (Diamondbacks)  
Stadium

Our team encountered numerous engineering challenges while designing the new Cold Beers and Cheeseburgers establishment within the existing Chase Field Stadium. Prior to multiple site walks, we conducted a thorough examination of the construction documents to devise a design that not only integrates seamlessly with the stadium's mechanical, plumbing, and electrical systems but also ensures the client remains within the budgetary constraints. To achieve this, we capitalized on existing building shafts and grease ductwork, as well as incorporating the space's existing hydronic system into our design. Similarly, we accomplished the same on the electrical and plumbing fronts by utilizing the existing boiler system and electrical panels available within the building.





# Select Projects.



**PRINCESS STORAGE**  
Scottsdale, AZ

**Quick Description:**  
100,000+ SF GROUND UP

Ardebili Engineering completed mechanical, plumbing, and electrical engineering for a new 100,000+ SF storage facility. The two-story building plus two basements posed a number of challenges to the design and engineering teams. Our engineers were limited on where equipment could be placed on the floorplan due to height restrictions of the building. The team was tasked with identifying system location that would comply with code, provide the needs of heating and cooling, and was also able to be physically installed. The team worked closely with the client to provide different options for the design of the project and modeled the HVAC system to be constructible while still meeting the client specific requirement for the design.

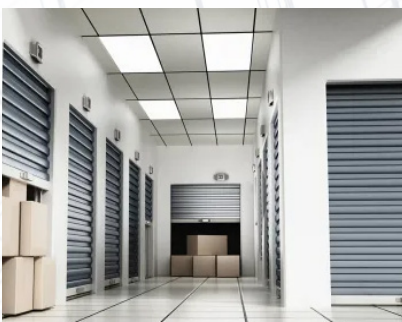

**FIGUEROA STORAGE**  
Los Angeles, CA

**Quick Description:**  
100,000+ SF GROUND UP

Ardebili Engineering completed mechanical, plumbing, and electrical engineering designs for Figueroa Street Self Storage in Los Angeles, CA, a fully conditioned, six story, 100,000+ SF storage facility with offices on the lower level. The five story building plus a basement posed a number of challenges to the team as there was a limitation to the drainage design on site. Our engineers had to design a system with the ability to drain the site into a lift station system inside the building to ensure the site would not flood. The team worked closely with the civil engineers and the architect to provide a cost effective design for the project, and modeled the system to be constructible while still meeting the city specific requirement for the design.



# Select Projects



## The Blue @ Eastline Tempe, AZ

**Quick Description:**  
218,000 SF Ground up  
Mixed-use Residential, Office,  
Retail

Ardebili Engineering provided comprehensive Mechanical, Plumbing, and Electrical services for a new 4-story multifamily mixed-use development in Tempe, AZ. The project blends modern design with functional amenities. It features a dual-level underground parking garage where our team engineered advanced ventilation, addressing air quality and circulation. Our team integrated a booster pump system to overcome the low water pressure available at the site and ensure adequate water pressure for all residents, while included a high-efficiency sewage ejector pump system to manage wastewater. A water softener system was also included in the design to ensure resident comfort and prolonged equipment life. A VRF system was utilized to maximize efficiency and zone control for common areas while at the same time elevating residents' living experience.

### SERVICES PROVIDED:

- Schematic Design, Design Development, Construction Documents



## Museum Square Scottsdale, AZ

**Quick Description:**  
87,825 SF Ground up  
Multi-story Apartment Complex

Ardebili Engineering offered comprehensive Mechanical, Plumbing, and Electrical services for a progressive 5-story multifamily development in Scottsdale, AZ. Our aim was to seamlessly merge sustainability with modern comforts. This project featured a two-level underground parking garage with ventilation system and an efficient sewage ejector pump system for wastewater management. Our team integrated a booster pump system to overcome the low water pressure available at the site and ensure adequate delivery pressure for all residents. A water softener system was also included in the design to ensure resident comfort and prolonged equipment life. A VRF system was utilized to maximize efficiency and zone control for common areas while at the same time elevating residents' living experience.

### SERVICES PROVIDED:

- Schematic Design, Design Development, Construction Documents



# Select Projects.



**CRIT Private School**  
Parker, AZ

**Quick Description:**  
**38,455 SF GROUND UP**

We have successfully completed the design for CRIT Private School in Parker, AZ. Our team's dedicated involvement during the initial design phase included seamless coordination of site planning with the Colorado River Indian Tribe. We also collaborated closely with HVAC manufacturers to carefully select a custom VRF mechanical system known for its exceptional energy efficiency. Furthermore, we addressed the challenges posed by limited roof spaces by designing a custom kitchen hood package that perfectly suited the project's requirements. Once the construction team breaks ground in the near future, we are excited to collaborate with them on the completion of this project. We eagerly anticipate working together to bring the vision to life.



# Experience - Storage Facilities

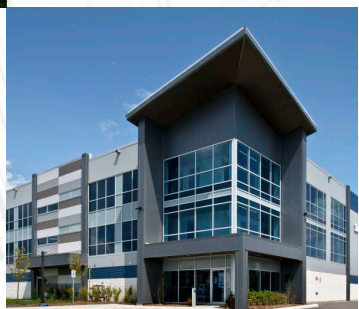
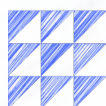

- 19th Ave Storage, 144K SF
- Assured 360 Storage, Ft. Worth 139K SF
- Blue Cloud Storage, 241K SF
- Capital Storage, CA 199K SF
- CubeSmart Self Storage, CA 63K SF
- El Mirage Storage, Surprise AZ 141K SF
- Falcon Storage Condos, 159K SF
- Foothills Storage, 133K SF
- Haltom Storage, Haltom TX 133K SF
- Indian School Storage, AZ 179K SF
- Irvington 19 Storage, 133K SF
- Liberty Self Storage, 170K SF
- Marana RV Storage, AZ 205K SF
- Marana Storage, AZ 200K SF
- NoHo Storage, 150K SF
- Platinum Storage, Citrus & Bethany 222K SF
- Platinum Storage, Metro Parkway 185K SF
- Rockwall Storage, 147K SF
- Royce City RV and Semi Storage, 206K SF
- RV and Boat Storage Yard, 186K SF
- Self Storage, Lubbock TX 144K SF
- Self Storage, Vista CA 180K SF
- Storage 365, 19th & Southern 136K SF
- Storage 365 Mesquite, TX 136K SF
- Storage 365, Honeycutt 150K SF
- Storage 365, Sweetwater 145K SF
- U-haul, Power Ranch 129K SF

**200+**

STORAGE PROJECTS

**12,500,000+**

SQUARE FEET ENGINEERED



# Experience - Medical & Dental

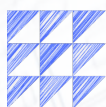

- ABHS Behavioral Health Center, McNary, AZ
- Agave Pediatrics, Goodyear, AZ
- Aurora Behavioral Health Center, Glendale, AZ
- Every Smile Dental, Mesa, AZ
- Honor Health Gastroenterology Offices, Phoenix, AZ
- Honor Health Primary & Urgent Care Facility, Scottsdale, AZ
- Honor Health Primary Care Sleep Center, Scottsdale, AZ
- Honor Health Primary Care, Scottsdale Rd, Scottsdale, AZ
- Honor Health Primary Care, Tempe, AZ
- Honor Health Thompson Peak, Scottsdale, AZ
- Honor Health TPK Primary Care, Scottsdale, AZ
- Next Care, Gilbert, AZ
- Premier Orthodontics Union Hills, Phoenix, AZ
- Surgery Center, 25K SF
- VA Hospital, Multiple projects
- Walman Eye Center, Phoenix, AZ
- West Valley Pediatric, Buckeye, AZ





# Experience - National Accounts

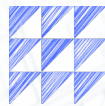

- 7-Eleven
- Circle K
- Club Pilates
- Cold Stone Creamery
- CorePower Yoga
- Cricket
- Cycle Bar
- Dickey's BBQ
- Dunkin'
- Fatburger
- Grabba Greens
- Orange Theory Fitness
- Popbar
- Popeye's
- Pure Barre
- Rumble Boxing
- Salad & Go
- Scooters
- Thai Express
- TruFusion
- Verizon
- Which Wich
- YogaSix





# Experience - Education

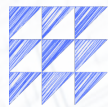

- American Leadership Academy West Foothills  
Approx. 56,000 SF, Waddell, AZ  
Description: MPE Services for Ground up 2 story theater.  
MECHANICAL PLUMBING IN REVIT  
ELECTRICAL IN AUTOCAD

- CRIT  
38,455 SF, Parker, AZ  
Description: MPE Services for Ground up School

- American Leadership Academy Sierra Vista  
38,031 SF, Sierra Vista, AZ  
Description: MPE Services for Ground up 2 Classroom Buildings, one Multipurpose Building, and a Field House

- Aces Phoenix  
12,008 SF, Phoenix, AZ  
Description: Electrical Engineering for and Addition to an existing building

- Phoenix Country Day School  
11,211 SF, Paradise Valley, AZ  
Description: MPE Services for Renovation and Expansion Project

- CAS High School  
6,200 SF, Douglas, AZ  
Description: MPE Services for Removing an old building and building the addition in its place.

- Bullhead city school  
3,215 SF, Bullhead City, AZ  
Description: MPE Services for Ground up School

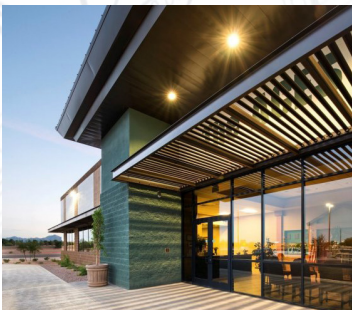



# Experience - Restaurant & Entertainment

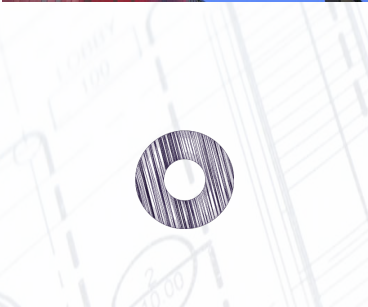

- Al Pastor, Phoenix, AZ
- Alamo DraftHouse, Tempe, AZ
- Angie's Lobster, Multiple Locations, AZ
- Aramark, Multiple Projects, AZ
- Barrio Queen, Phoenix, AZ
- Barros Pizza Multiple Locations, AZ
- Bourbon and Bones, Multiple Locations
- Buck & Rider, Multiple Locations, AZ
- Chick-fil-A, Tempe, AZ
- Chula's Seafood, Scottsdale, AZ
- Cold Beer & Cheeseburgers, Multiple, AZ
- Copper Blues Comedy Club, Oxnard, CA
- Edley's BBQ, Multiple Locations, TN
- Elote Cafe, Sedona, AZ
- Fate Brewing, Scottsdale, AZ
- Goldwater Brewery, Scottsdale, AZ
- Humble Pie, Scottsdale, AZ
- Ingo's, Scottsdale, AZ
- Jin Jia - Desert Ridge, Scottsdale, AZ
- Kembara Desert Ridge, Scottsdale, AZ
- Macayo's Mexican Table, Multiple Locations
- Merkins Vineyard, Cottonwood, AZ
- Modern Round, Peoria, AZ
- Ojos Locos, Multiple Locations
- Over Easy, Multiple Locations, AZ
- Pei Wei, Memorial Union ASU, Tempe, AZ
- Roll'em Up Taquitos, Multiple Locations, AZ
- Sizzle, Arrowhead Mall, AZ
- Sorso Wine Room, Scottsdale, AZ
- Starbucks, ASU Campus Locations, AZ
- Thai Chili To Go, Maricopa, AZ
- The Clayton House, Scottsdale, AZ
- Trail West, Scottsdale, AZ
- US Eggs, Scottsdale, AZ
- Zipps Sports Grill, Phoenix, AZ





# Experience - Corporate Office

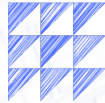

- 24/7 In-Touch Offices, Mesa, AZ
- Anasazi Plaza, Phoenix, AZ
- Arizona Water Company, Phoenix, AZ
- Chasse Building Team, Tempe, AZ
- Control Tower Small Arms, US Army
- Ideas Collide, Scottsdale, AZ
- Indwell Custom Cabinetry, Phoenix, AZ
- JDM Countertops, Phoenix, AZ
- Nelipak Office Space, Cranston, RI
- Scottsdale Promenade, Scottsdale AZ
- Spinato's Fine Foods Production Line, Tempe, AZ
- Surgenex Regenerative Medicine Headquarters, Scottsdale, AZ
- WTPC Office, Tempe, AZ





# Experience - Industrial / Warehouse

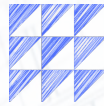

- AirComm Industrial Office Tempe AZ 31K SF
- Bobs Furniture Tucson AZ 88K SF
- Bram Flooring Warehouse AZ 14K SF
- Cabinetry Warehouse TI 52K SF
- Dalewood Warehouse 20K SF
- Deer Valley Warehouse Phoenix AZ 16K SF
- Fountain Hills TI 9K SF
- Law Tigers Warehouse 11K SF
- Manufacturing Facility 51K SF
- National Gypsum 531K SF
- Nelipack Healthcare packaging Phoenix AZ
- Portal Warehouse Tempe AZ 27K SF
- Power Office and Warehouse 21K SF
- Seafood Warehouse Addition 6K SF
- Setna IO Tempe AZ 11K SF
- Solar Warehouse 125K SF
- Sports Center Lake Forest CA 50K SF
- Tacoma Seattle Box company 100K SF
- True Spec Golf Warehouse 14K SF
- Warehouse TI Thunderbird & 32nd 11K SF





# Experience - Mixed Use

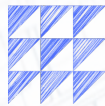

- BLUE at Eastline Village 180k SF, Tempe, AZ  
Description: MPE Services for 2 new 4-story residential mixed-use buildings

- The Artisan, 84K SF, Scottsdale, AZ  
Description: MPE Services for ground-up apartment, retail & office project

- 75 on 2nd Apartments, 71K SF, Phoenix AZ  
Description: MPE Services for a 4 story boutique apartment complex

- Mixed Use TI, 71K SF, San Diego, CA  
Description: MPE Services for renovation of a residential mixed-use building

- 12 High, 69K SF, Phoenix, AZ  
Description: MPE Services for 22,850 SF Mixed-Use, 45,700 SF Apartments

- Parkview Mixed-Use 25K SF, Scottsdale, AZ  
Description: MPE Services for ground up Multi-Purpose building

- 32nd Street North, 20K SF, Phoenix, AZ  
Description: MPE Services for a Multi-use building consist of Office, Retail and Dining

- Sunshine Acres, 17K SF, Mesa, AZ  
Description: MPE Services for ground up Multi-Purpose building

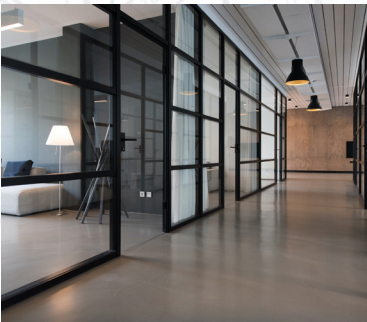



# Experience - Multifamily & Hotel

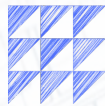

- Museum Square, 88K SF, Scottsdale, AZ
- The Artisian, 79K SF, Scottsdale, AZ
- 77 on the Park, 49K SF, Scottsdale, AZ
- 7th St Multi-Family, 37K SF, Phoenix, AZ
- Aspire Elite Phoenix Fairway Greens Apartments, 170K SF, Phoenix, AZ
- Cibola Vista Resort & Spa, 34K SF, Peoria, AZ
- Crown Point Apartments, 125K SF, Prescott Valley, AZ
- Blue at Eastline Village Mixed-Use, 200K SF, Tempe, AZ
- Glendale West Apartments, 46K SF, Glendale, AZ
- Hampton Inn & Suites, 63K SF, Indio, CA
- Hampton Inn & Suites, 79K SF, Lake Tahoe, CA
- Holiday Inn Express, 54K SF, Gresham, OR
- Home2 Suite & Tru by Hilton, 111K SF, Madison, WI
- Legacy Hotel, 59K SF, Phoenix, AZ
- Museum Square Apartments, 88K SF, Scottsdale, AZ
- Redwood Apartments, 80K SF, Sonoma County, CA
- Springhill Suites, 65K SF, Vancouver, WA
- Tru Hotel, 45K SF, Barstow, CA



# Experience - Residential

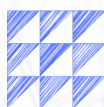

- 8436 N Golf Drive 11,131 SF
- 91st Place Casita 3,000 SF
- Campbell Residence 5,700 SF
- Carefree Ranch Residence 5,764 SF
- Dr Askari Residence 8,000 SF
- Ford Residence 10,500 SF
- Gala Residence Additions 7,675 SF
- Garrett Family House 7,000 SF
- Jomax Residence 12,000 SF
- Lot 1 Cantabrica 11,700 SF
- Lot 136 Whisper Rock 5,600 SF
- Lot 195 Estancia 5,500 SF
- Lot 212 Estancia 6,100 SF
- Lot 264 Estancia 8,500 SF
- Lot 30 Estancia 6,300 SF
- Lot 4 Cantabrica 10,600 SF
- Lot 5 Cochise Geronimo Village 5,000 SF
- Lot 60 Estancia 6,700 SF
- Lot 8 - Cantabrica 12,700 SF
- Lots 14 & 15 Esperanza 10,000 SF
- Plaza Lofts 3,300 SF
- Ripp's Residence Remodel 2,900 SF
- The Berry Cabin 4,200 SF
- Webster Residence 5,500 SF





# Experience - Worship & Public Works

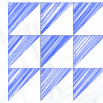

- AZ Game & Fish Bubbling Ponds, Phase 1&2, Cornville, AZ
- AZ Game & Fish, Horseshoe Ranch Storage Facility, Cordes Lake, AZ
- AZ Game & Fish, Lake Havasu Law Enforcement Aid Station, Lake Havasu, AZ
- AZ Game & Fish, Standard House, Lake Havasu, AZ
- Chino Valley Police Station, AZ
- Grace Fellowship Church, Riverside, CA
- Harvest Bible Church, Mohave Valley, AZ
- Phoenix Memorial Park, New Mausoleum, Phoenix, AZ
- Salt River Assembly of God, Peoria, AZ
- US / Canada Export Building Renovation, Champlain, NY
- Valley Life Church, Phoenix, AZ
- Vietnamese Fellowship Hall, Phoenix, AZ





# Experience - Hazardous

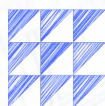

- Triumvirate Integrated Waste Management Facility  
48,000 SF  
Casa Grande, AZ  
Description: Hazardous waste building that includes corrosive liquids, processing, segregated container storage, acids, bases, neutrals, flammable liquids and solids and heavy metal soils/liquids with metal areas



- Salt River Materials Laboratory  
10,000 SF  
Clarkdale, AZ  
Description: Laboratory



- Ultra Health II  
5,000 SF - Tenant Improvement  
Scottsdale, AZ  
Description: Testing Lab
- Exterior Hazardous Material Storage Building  
3,000 SF  
Snowflake, AZ  
Description: Building holds several hazardous materials used in the client's growing and extraction processes

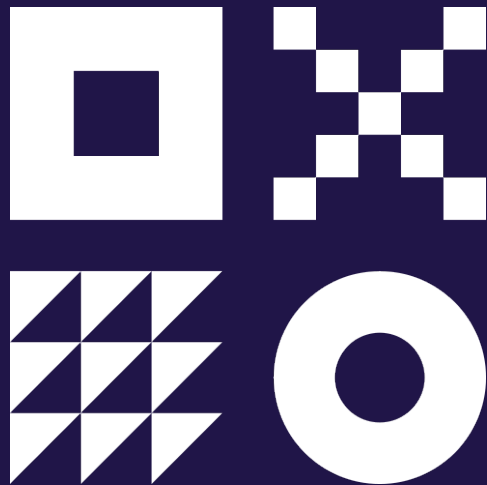

Let's Engineer the Future Together.



480.626.7072



[info@Ardebilieng.com](mailto:info@Ardebilieng.com)



[www.Arbabilieng.com](http://www.Arbabilieng.com)



**Ardebili Engineering Headquarters**

7328 E Stetson Dr.  
Scottsdale, AZ 85251

**Ardebili Engineering Dallas**

12377 Merit Dr, Ste 230.  
Dallas, TX 75251

**Ardebili Engineering Mexico**

Blvd. Luis Donaldo Colosio Murrieta 450,  
83250 Hermosillo, SON. Mexico  
(Edificio Metrocentro Local 6 Piso 6)

**Ardebili Engineering Turkey**

Atifbey Mah. Akcay Cad. No.278/3 D.1  
Gaziemir Izmir. Turkey